



Solid Nozzles - Tool Steel

Please email completed form to: dmeus-csspecials@dme.net

Internal Designs

General Purpose

Standard, free-flow internal design General Purpose Nozzle, provides minimum flow resistance and back pressure buildup; 1/2" diameter flow path unless otherwise stated.

Nylon Reverse Taper

For use with polyamides, acrylics, and similar expansive and heat-sensitive materials. Material flows 1 1/2" through 1/8" diameter-restricted throat into 1" long reverse taper. Sprue breaks inside nozzle providing expansion area and reducing drool.

Full Taper - ABS

For use with ABS, PVC and other viscous hard-flow materials. Reduces frictional heat and areas of hangup. Recommended large orifices for minimum flow resistance. Taper 3" longitudinal distance from rear opening to 1/2" internal bore.



Hardened Chrome Vanadium tool steel for long life

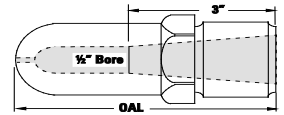
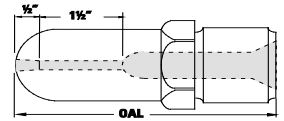
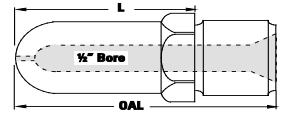

| Description | Total Length |
|-----------------------------|--------------|
| Thread dia. up to 2" (50mm) | 5" |
| | 6" |
| | 7" |
| | 8" |
| | 9" |
| | 10" |
| | 12" |
| | 14" |
| | 16" |
| | 18" |
| 20" | |

| Description | Total Length |
|---|--------------|
| Thread dia. 2 1/8" to 2 3/4" (51mm to 69mm) | 5" |
| | 6" |
| | 7" |
| | 8" |
| | 9" |
| | 10" |
| | 12" |
| | 14" |
| | 16" |
| | 18" |
| 20" | |

Hardened Chrome Vanadium tool steel. Polished to mirror finish to provide smooth material flowpath. These nozzles will provide far greater life and superior flow characteristics than relatively soft, "T" - condition nozzles.



How to Order:

1. Specify make and model of machine plus style of nozzle.
2. Specify radius and orifice. Options—TC hole on hex flat

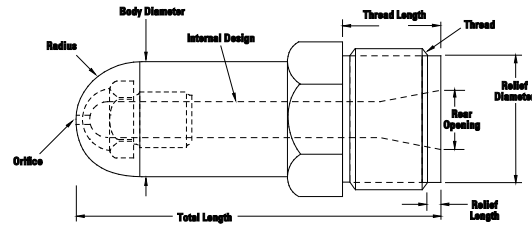

Complete the information below and fax to DME at 248-544-5113) or email to DME@dme.net.

| | | | |
|-----------------------------------|-------|---|-------|
| 1. Total Length | _____ | 6. Radius (Flat, 1/2", 3/4", 35 mm) | _____ |
| 2. Thread Length | _____ | 7. Orifice | _____ |
| 3. Thread Type (1 1/2" - 12 etc.) | _____ | 8. Internal Design (general purpose, nylon reverse taper or ABS full taper) | _____ |
| 4. Rear Openings | _____ | 9. Relief Diameter | _____ |
| 5. Body Diameter (1", 1 1/2", 2") | _____ | 10. Relief Length | _____ |
| MACHINE MAKE: | _____ | MODEL: | _____ |
| | | YEAR: | _____ |

Company: _____
 Account Number: _____
 Address: _____
 City: _____
 State/Zip: _____

Contact Name: _____
 Phone: _____
 Fax : _____
 E-mail: _____