



FROM PELLET TO PART
YOUR PARTNER
FOR PRODUCTIVITY
AND SUSTAINABILITY



DME StellarONE

OPTIMIZED HOT RUNNER SYSTEM SOLUTIONS
FOR INJECTION MOLDING

The DME Hot Runner Evolution continues...

StellarONE is the next generation in DME's long line of hot runner product offerings. StellarONE combines the best of DME's legacy systems with modern hot runner technology. Available in both thermal and valve gate configurations, six flow paths and several gate options, the modular StellarONE is an incredibly flexible and competent hot runner system supporting a very wide range of resins, including many complex engineering resins.

StellarONE is a true global platform, with service and component availability in North America, Europe and Asia. Designed to compete with advanced systems yet reasonably priced.



StellarONE RETHINKING MELT DELIVERY

Precision Temperature

Our heater technology offers stable heating with minimal heat loss. Direct heating via replaceable brass sleeve heaters for diffusion into the nozzle body. Thermocouples are ideally positioned for accurate temperature control, all serviceable within the molding machine. The result is an even temperature profile along the entire length of the nozzle, guaranteeing high process reliability and repeatability.

StellarONE's tip designs minimize melt residency in the gate well to ensure quick color change performance.

Extreme Durability

DME systems are built to perform through the life cycle of the tool 24/7, by incorporating hardened nozzle bodies and wear resistant tip needles and manifolds when the application requires it.

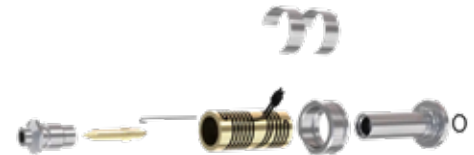

Standardized nozzle components

across the family ensures global availability of replacement parts. Tips are serviceable with the mold in the IMM, by removing the cavity plate.

StellarONE HOT RUNNER SYSTEMS

Features:

- Six different nozzle sizes to match your application requirements:
 - 4, 6, 8 & 10 mm** flow paths standard nozzle lengths 50-180mm
 - 12 & 16mm** flow paths standard nozzle lengths 50-300mm
- Tip options include Sprue and Extended sprue gates, Bodiless and Full Body point gates
- Clean flow path and tip designs enable rapid color changes
- Valve gate actuator cylinders Pneumatic and Hydraulic, 700 PSI maximum operating pressure
- Valve gate actuation options include individual (sequential) or all open/all closed
- Available for 2- to 32-drops using a thermally and geometrically balanced manifold





FROM PELLET TO PART
YOUR PARTNER
FOR PRODUCTIVITY
AND SUSTAINABILITY



DME StellarONE

OPTIMIZED HOT RUNNER SYSTEM SOLUTIONS
FOR INJECTION MOLDING

Benefits:

- Thoroughly engineered, cost effective system
- Replacement / spare part availability globally
- Valve Gate nozzles available for sequential part filling and / or superior gate cosmetics
- Valve Gate Cylinder design allows removal or setting of Valve Pins without system disassembly
- Easily matched with DME temperature and valve gate control systems
- Regional service centers around the world

StellarONE Hot Runner Manifolds are designed with balanced runner systems to efficiently deliver the melt to the cavity. Design selection is based on process variables such as resin, shot size, gate vestige and overall system performance requirements.

- Complete hot half assemblies are fully assembled and power tested, ready to bolt onto the mold base, eliminating the need for machining, wiring and testing before the mold trial run
- All Manifold & Component systems come complete with: Tubular Heaters, Thermocouples, Titanium Pressure Pads, Manifold & Nozzle Locators as required
- All Manifold & Component systems are supplied with full system drawings
- Tubular Heating Elements provide excellent heat distribution throughout the manifold and standard replacement parts are available globally for "off the shelf" quick delivery
- Hardened Steel Construction, the foundation for a long service life



Suitable for:

TPE (Elastomer)
PE (Polyethylene)
PE GF (Polyethylene)
PS (Polystyrene)
PS GF (Polystyrene)
SAN
TPO
PP (Polypropylene)

PP GF (Polypropylene)
PPTF (Polypropylene)
TPU
ABS
ABS/PC
PMMA (Acrylic)
POM (Acetal)
PA (Nylon)

PA GF (Nylon)
PA MF GF (Minlon) PPE
PPO (Noryl)
PPO GF (Noryl)
PBT Polyester
PBT GF Polyester
PET
PC (Polycarbonate)

PC GF (Polycarbonate)
PPS
PSU
PSU GF
PUR (Urethane)

COMPLETE CARE

From Single Nozzles To Fully Assembled Hot Halves ... And Everything In Between

In the relentless drive to reduce costs, improve part quality and speed time to market, hot runner systems are increasingly in demand. But every application is unique. DME would like to be your design partner to ensure the system is engineered to meet every critical aspect of your part production.



STONE-3.18.24

US- 800-626-6653 / DME@DME.net
Canada- 800-387-6600 / DME_Canada@DME.net